

THIS DOCUMENT IS TRUE AND CORRECT AT TIME OF PUBLICATION. CONTINUED PRODUCT IMPROVEMENTS MAKE SPECIFICATIONS AND MEASUREMENTS SUBJECT TO CHANGE WITHOUT NOTICE.

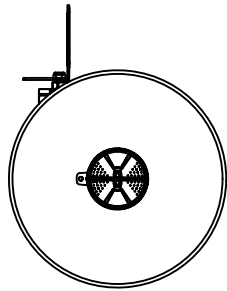

TOP VIEW

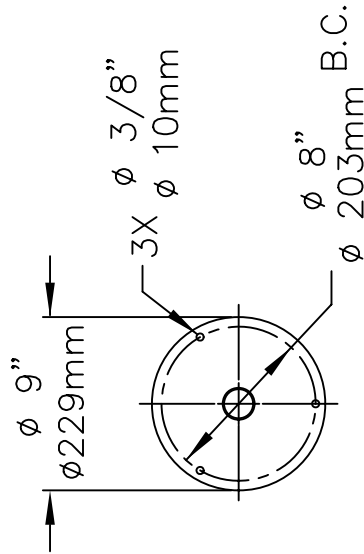

MOUNTING DETAIL

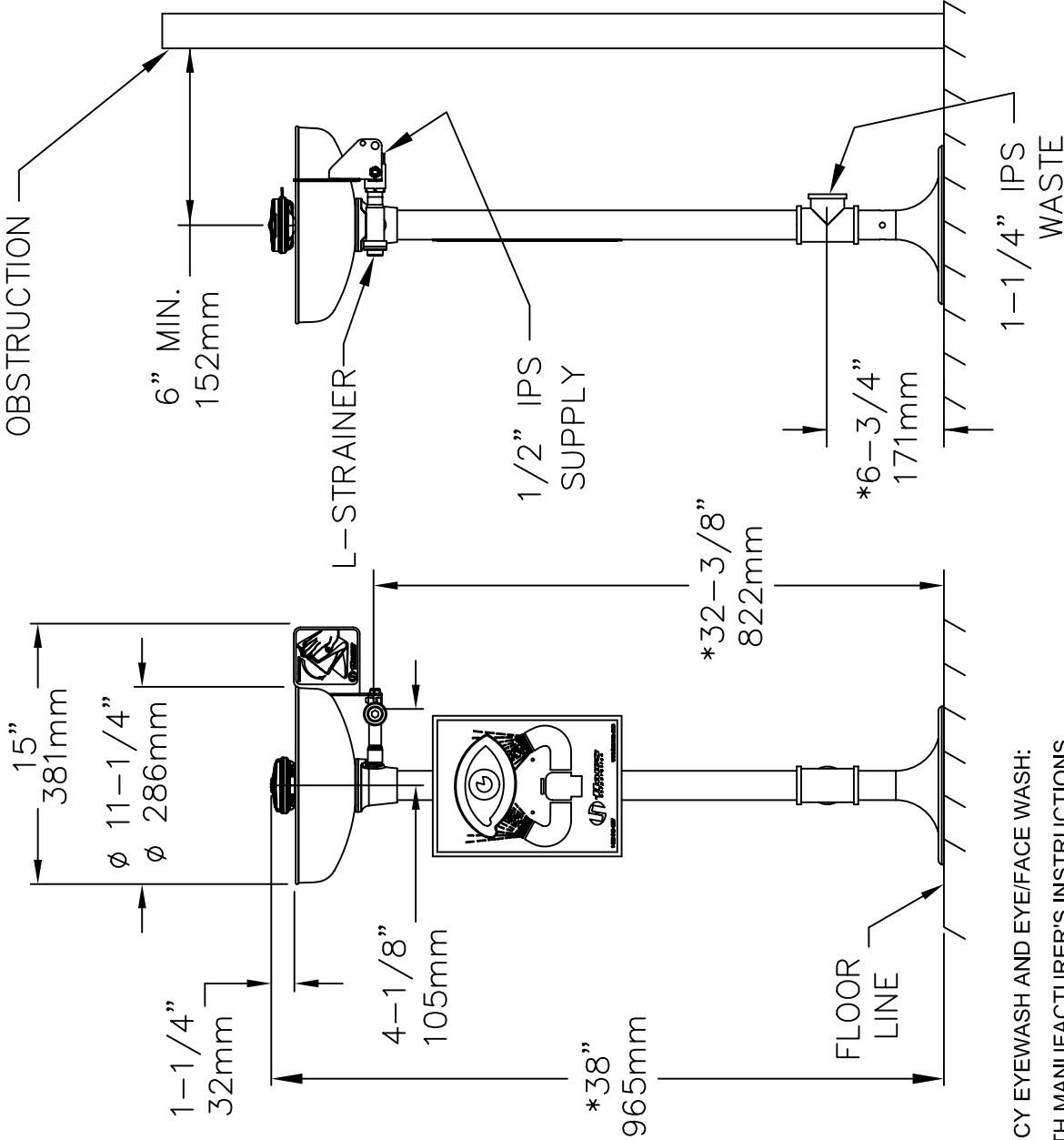

NOTES:

- TO COMPLY WITH ANSI Z358.1-2004 FOR EMERGENCY EYEWASH AND EYE/FACE WASH:
  - UNIT SHALL BE INSTALLED IN ACCORDANCE WITH MANUFACTURER'S INSTRUCTIONS AND ACCEPTABLE PLUMBING PRACTICES.
  - EYEWASH OR EYE/FACE WASH SHALL BE POSITIONED WITH NOZZLES NOT LESS THAN 83.8 CM (33 IN.) AND NO GREATER THAN 114.3 CM (45 IN.) FROM SURFACE ON WHICH USER STANDS AND 15.3 CM (6 IN.) MINIMUM FROM WALL OR NEAREST OBSTRUCTION.
- \*THESE DIMENSIONS MAY VARY

±1/2" [12.7mm]

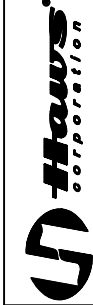

INFO FAX : 1-888-FAX-HAWS (1-888-329-4297)  
 1455 Kleppe Ln, Sparks NV, 89431  
 Phone: 775-359-4712 Fax: 775-359-7424  
 Haws Ag, Bachweg 3, CH-3401 Burgdorf, Switzerland  
 Haws Mfg Pte Ltd 74, Sungai Kadut Loop, Singapore 729531  
 e-mail: haws@hawsco.com website: www.hawsco.com

FORM NO.	REVISED PER	ISS.	MODEL(S)
ECNS-4161	IR	7361/7461	
DATE:	02/91	PKWT:	INFO FAX DOC # 27361_27461
APPROVED:	DATE:	SCALE:	E/S
			DRAWING TYPE: INSTALLATION/FABRACK
			SIZE: A
			SHEET 1 OF 1
			0007080056.D
			09708A00
			11