



T&S BRASS AND BRONZE WORKS, INC.

2 Saddleback Cove / P.O. Box 1088
Travelers Rest, SC 29690



REG. #A2601
ISO #9001

Model No.

B-0305

Item No.

Travelers Rest, SC: 800-476-4103 Simi Valley, CA: 800-423-0150 Fax: 864-834-3518 www.tsbrass.com

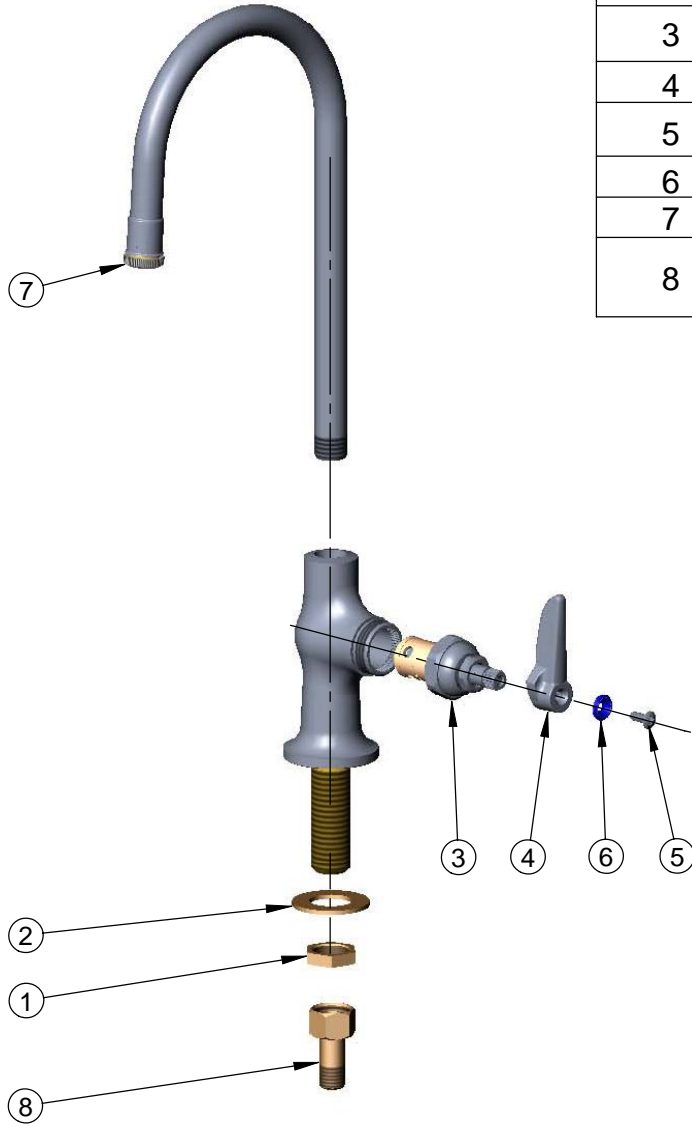

ITEM	PART NO.	DESCRIPTION
1	002954-45	Shank Lock Nut
2	000999-45	Brass Lock Washer
3	005960-40	Eterna Spindle Asm, Hot
4	001638-45	Lever Handle
5	000922-45	Lever Handle Screw
6	001660-45	Blue Index-CW
7	120X	Rigid GN w/ B-LT
8	150A	Bag of (1) Nut & (1) Tailpiece

Product Specifications:

Single Temperature Deck Mount Faucet w/ Lever Handle,
Eterna Cartridge & Rigid Gooseneck w/ B-LT Stream Regulator
Outlet

Drawn

KJG

Checked

GEF

Approved

JHB

Scale:

NTS

Date:

12/09/08