

CHICAGO FAUCETS 

a Geberit company

2100 South Clearwater Drive
Des Plaines, IL 60018
Phone: 847-803-5000
Fax: 847-803-5454
www.chicagofaucets.com

FOR TECHNICAL ASSISTANCE
1-800-TEC-TRUE (1-800-832-8783)

REPAIR PARTS

BY: SID DATE: 09-03-09
CHK: *[Signature]* REV:

| | |
|---------------------|------------------|
| FITTING NO. | 350-GN8AE3-317CP |
| SUBMITTED MODEL NO. | |
| ITEM NO. | |

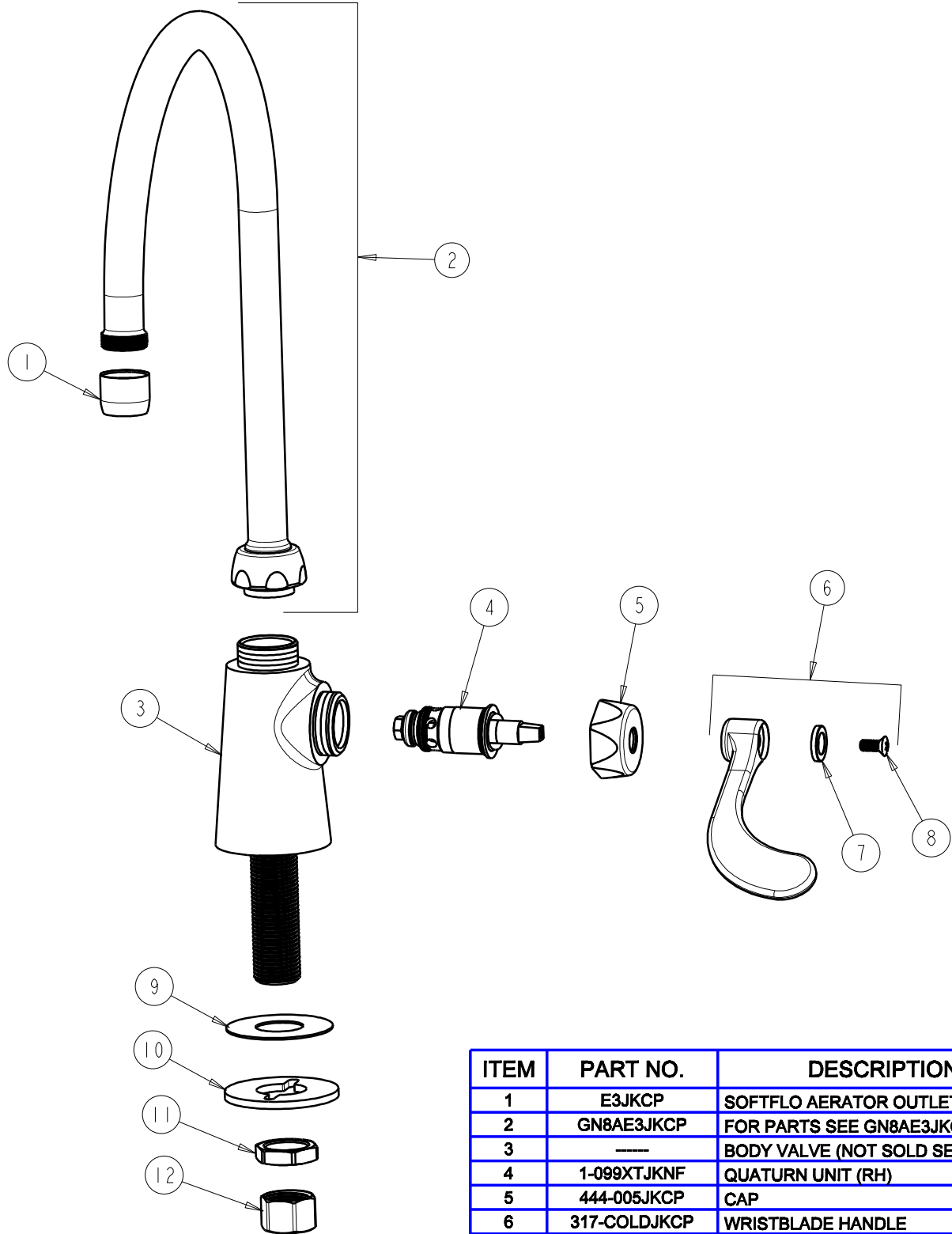

| ITEM | PART NO. | DESCRIPTION |
|------|--------------|----------------------------------|
| 1 | E3JKCP | SOFTFLO AERATOR OUTLET |
| 2 | GN8AE3JKCP | FOR PARTS SEE GN8AE3JKCP |
| 3 | ---- | BODY VALVE (NOT SOLD SEPARATELY) |
| 4 | 1-099XTJKNF | QUATURN UNIT (RH) |
| 5 | 444-005JKCP | CAP |
| 6 | 317-COLDJKCP | WRISTBLADE HANDLE |
| 7 | 633-123JKNF | INDEX BUTTON (BLUE) |
| 8 | 420-010JKRCF | SCREW, 10-32 UNC PH 1/2 |
| 9 | 52-007JKNF | WASHER, RUBBER |
| 10 | 807-112JKNF | WASHER |
| 11 | 49-004JKRBF | LOCKNUT |
| 12 | 49-005JKRBF | COUPLING NUT |