

SPEAKMAN®

SE-921 DRENCH HOSE

DESCRIPTION

The SE-921 counter top mounted drench hose featuring self-closing valve, aerated spray, 6' hose and flip-top dust covers.

SPECIFICATIONS

Spray Heads: Aerated, yellow plastic spray outlet and dust cover

Valve: 3/8" NPT female brass, chrome-plated

Activator: Brass, chrome-plated squeeze handle

Hose: 6' reinforced

Flange: Chrome-plated brass

Inlet: 3/8" NPTM with swivel connection

Performance: 1.5 gpm @ 30 psi

Compliance: ANSI Z358.1

OPTIONS

- SSHSE Stainless steel hose
- TEW Twin eyewash
- VB Vacuum breaker

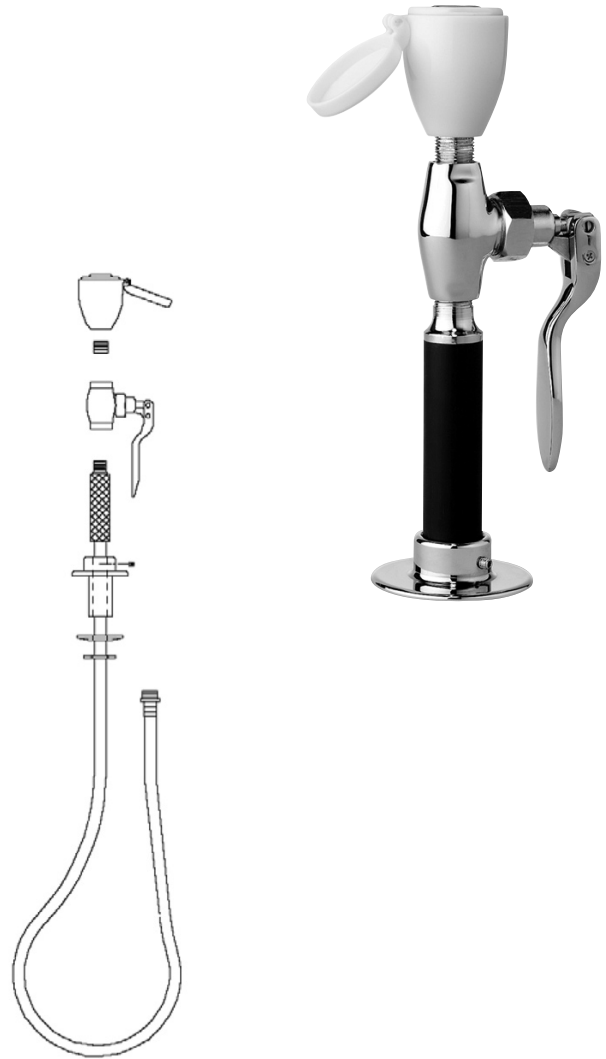

Job Name _____
Location _____
Architect/Engineer _____
Sales Representative _____
Wholesaler _____
Date _____ Model # _____