

SPEAKMAN®

SE-922 DRENCH HOSE

DESCRIPTION

The SE-922 counter top mounted drench hose featuring stay open valve, 6' hose and flip-top dust covers.

SPECIFICATIONS

Spray Heads: Yellow plastic spray outlets with flip-top dust caps and an automatic flow control

Valve: 3/8" NPT female brass, chrome-plated

Activator: Brass, chrome-plated squeeze handle

Hose: 6' reinforced

Flange: Brass, chrome-plated

Inlet: 3/8" NPT male, swivel connection

Performance: 1.6 gpm @ 30 psi

Compliance: ANSI Z358.1

OPTIONS

- SSHSE Stainless steel hose
- VB Vacuum breaker
- XHS Extended hose

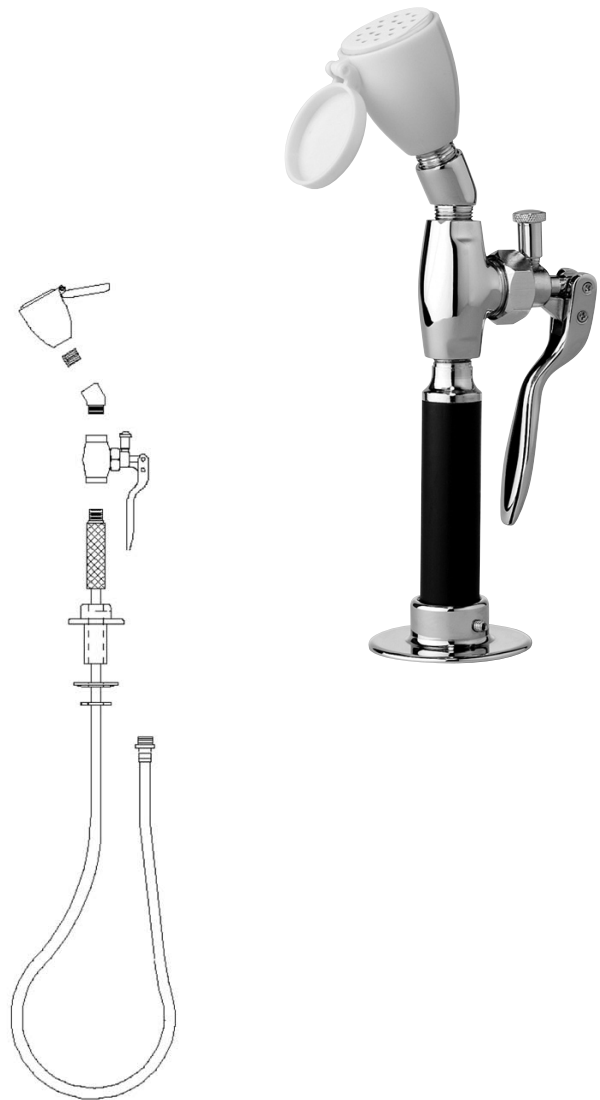

Job Name _____
Location _____
Architect/Engineer _____
Sales Representative _____
Wholesaler _____
Date _____ Model # _____