



# T&S BRASS AND BRONZE WORKS, INC.

2 Saddleback Cove / P.O. Box 1088  
Travelers Rest, SC 29690



REG. #A2601  
ISO #9001

Model No.

**B-6K**

Item No.

Travelers Rest, SC: 800-476-4103 Simi Valley, CA: 800-423-0150 Fax: 864-834-3518 www.tsbrass.com

This Space for Architect/Engineer Approval

Job Name \_\_\_\_\_ Date \_\_\_\_\_

Model Specified \_\_\_\_\_ Quantity \_\_\_\_\_

Customer/Wholesaler \_\_\_\_\_

Contractor \_\_\_\_\_

Architect/Engineer \_\_\_\_\_



**013430-45**  
**ETERNA SPINDLE PACKING SEAL**  
(replaces 001063-45, 001098-45 & 009745-45)  
(QTY 6)

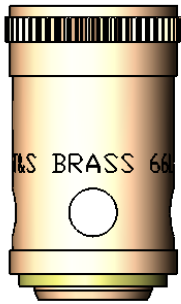

**000788-20**  
**REMOVEABLE ETERNA**  
**INSERT-RIGHT HAND**  
**WITH GASKET**  
(QTY 1)

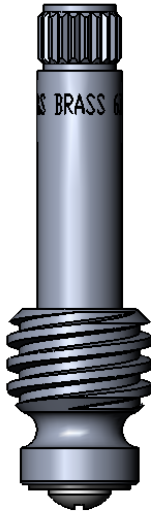

**000811-25**  
**RIGHT HAND SPINDLE**  
(QTY 1)

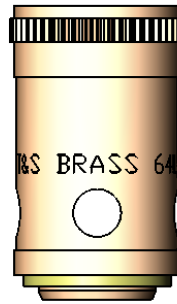

**000789-20**  
**REMOVEABLE ETERNA**  
**INSERT-LEFT HAND**  
**WITH GASKET**  
(QTY 1)

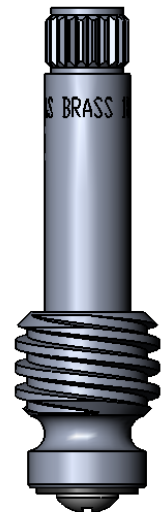

**000812-25**  
**LEFT HAND SPINDLE**  
(QTY 1)

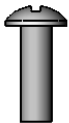

**000933-45**  
**SCREW**  
(QTY 4)

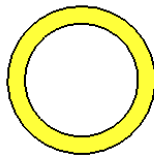

**001022-45**  
**GASKET**  
(QTY 10)

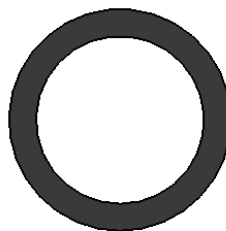

**002601-45**  
**GASKET**  
(QTY 12)

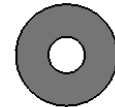

**001092-45**  
**SEAT WASHER**  
(QTY 22)

Product Specifications:  
**JOB PARTS KIT**

Drawn  
JRM

Checked  
MAV

Approved  
JHB

Scale:

1:1

Date:

03/12/07