

# ELKAY® SPECIFICATIONS

## No Lead Drinking Fountain Soft Sides® Wall Mount – Fully Exposed Barrier-Free Access Model EDFP214C

### GENERAL

**EDFP214C:** Wall mounted drinking fountain constructed of #18 gauge, type 304, stainless steel polished to a satin finish.

Contoured basin minimizes splashing and has exclusive Flexi-Guard® safety bubbler to prevent accidental mouth injuries. Keyed in location to prevent rotation. Easy to operate, fully functional push-button is vandal-resistant. Stainless steel bottom cover plate included. Patented\* valve and in-line flow regulator provides stream from 20 to 105 psi.

**THIS DRINKING FOUNTAIN COMPLIES WITH THE REQUIREMENTS OF A.D.A. (AMERICANS WITH DISABILITIES ACT) WHEN PROPERLY INSTALLED.**

### NO LEAD DESIGN

**THIS DRINKING FOUNTAIN COMPLIES WITH THE LEAD-FREE DEFINITION IN THE SAFE DRINKING WATER ACT OF 1986 AND LEAD CONTAMINATION CONTROL ACT OF 1988.**

Elkay Drinking Fountains are manufactured with a waterway system utilizing copper components and completely lead-free material. These waterways have no lead because all leaded materials, such as leaded brass, have been removed.

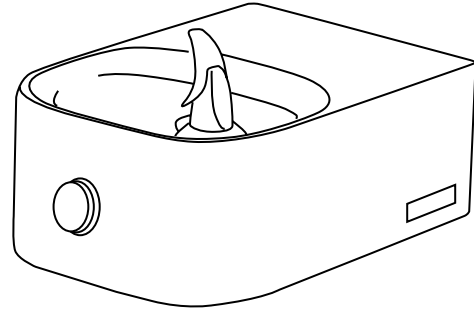

Model EDFP214C

### CONSTRUCTION

**EDFP214C** furnished complete with Flexi-Guard®, fully assembled front push-button, patented\* valve and in-line flow regulator (20 to 105 psi), and LK464 drain and trap assembly. Stainless steel bottom cover plate.

**Exclusive Flexi-Guard® Safety Bubbler\*:** Innovative design utilizes an infused anti-microbial pliable polyester elastomer to prevent accidental mouth injuries. Flexes on impact, then returns to original position. Strong. Abrasion-resistant. Anti-sweat. Keyed in location to prevent rotation.

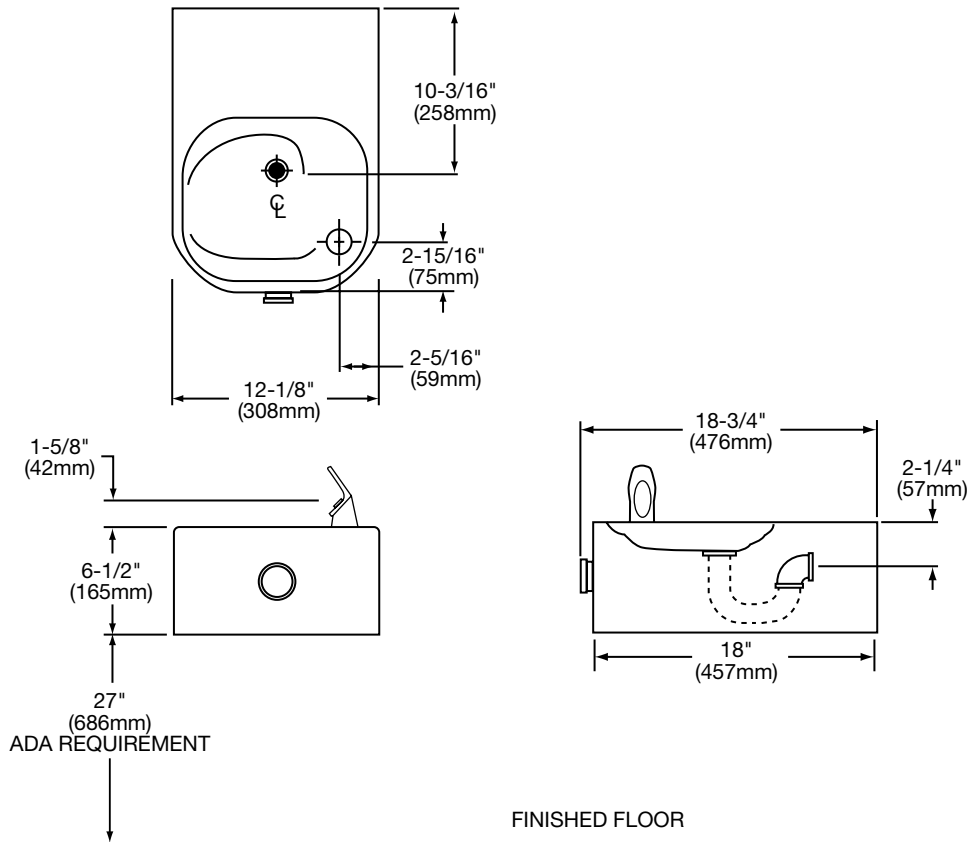

\* Patent #4,481,971

*In keeping with our policy of continuing product improvement, Elkay reserves the right to change product specifications without notice.*

*This specification describes an Elkay product with design, quality and functional benefits to the user. When making a comparison of other producers' offerings, be certain these features are not overlooked.*

**No Lead Drinking Fountain Soft Sides®**  
**Wall Mount - Fully Exposed**  
**Barrier-Free Access**  
**Model EDFP214C**

**ELKAY®**  
**ROUGH-IN DIMENSIONS**

**INSTALLER NOTE**

THIS DRINKING FOUNTAIN IS FURNISHED WITH A BUBBLER AND VALVE INCLUDING ALL CONNECTING FITTINGS WHICH ARE MANUFACTURED OF COMPLETELY LEAD FREE MATERIAL. IT IS RECOMMENDED THAT SHUT OFF VALVE AND SUPPLY TUBING SUPPLIED BY OTHERS BE NON-METALLIC.

**OPERATION OF QUICK CONNECT FITTINGS**

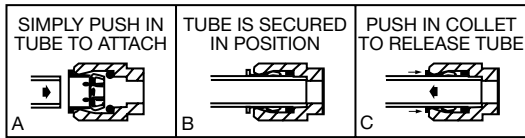

PUSHING TUBE IN BEFORE PULLING IT OUT HELPS TO RELEASE TUBE

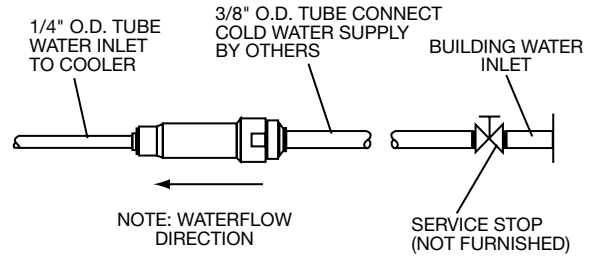

**WALL ROUGH-IN**

