

MODELS HBW 8A and 13A

HBW 8A and 13A PART LIST

REF NO.	PART NUMBER	DESCRIPTION	HBW8A	HBW13A	HBW L/Refrig
1	16-03165-08-840	Projector	X	X	X
2	10-03227-40-560	Projector Gasket (2 each)	X	X	X
3	16-06092-08-550	Projector Nipple	X	X	X
4	60-14801-51-550	Regulator Assembly*	X	X	X
4a	60-14240-51-550	Valve Assembly* (included in item 4)	X	X	X
4b	60-08050-51-550	Diaphragm Repair Kit* (for item 4)	X	X	X
4c	60-14202-51-550	Valve Stem Assembly* (included in item 4)	X	X	X
5	60-10337-51-590	Push Button Stem Assembly*	X	X	X
6	40-14901-43-730	Lever Arm for Push Button Assembly	X	X	X
7	60-27040-51-550	Wasteline	X		X
8	60-27039-51-550	Wasteline/Precooler Assembly		X	
8a	16-02705-08-840	Strainer Plate (included in item 8)	X	X	X
8b	10-26399-31-840	Drain Plug (included in item 8)	X	X	X
9	10-01471-40-560	Waste Gasket	X	X	X
10	40-26070-31-550	Precooler Baffle		X	
11	17-10300-42-830	Receptor	X	X	X
12	40-14954-43-730	Upper Receptor Hanger (not shown)	X	X	X
13	40-06609-43-730	Lower Hanger Bracket (not shown)	X	X	X
14	60-10330-51-550	Lowside Assembly	X	X	
15	16-01453-08-550	Tank Plug	X	X	
16	19-42339-51-550	Primary Temperature Control (adjustable)	X	X	
17	19-15342-51-550	Secondary Temperature Control (nonadjustable)	X	X	
18	10-10800-51-010	Drier	X	X	
19	60-08394-51-550	Compressor Assembly	X	X	
19a	19-07765-51-550	Relay (included in item 19)	X	X	
19b	19-07724-51-550	Overload (included in item 19)	X	X	
20	60-10333-51-550	Fan Motor Assembly	X	X	
20a	19-06487-04-550	Fan Blade (included in item 20)	X	X	
20b	41-06286-51-730	Fan Bracket (included in item 13)	X	X	
21	NO LONGER AVAILABLE	Shroud	X	X	
22	19-10301-51-550	Condenser	X	X	
23	40-10315-43-XXX	Wrap-Around Panel	X	X	X
24	13-14419-31-560	Name Plate (not shown)	X	X	X
25	19-26676-51-550	Wiring Assembly	X	X	
26	11-07119-42-550	Receptor Screws (4 each)	X	X	X
27	11-03094-43-890	Panel Screws (2 each)	X	X	X

ACCESSORIES AVAILABLE

Vandal Proof Kit - 73-15243-51-640*

Water Filtration Kit - 73-15242-51-550* (mounts external to cooler)

73-15423-51-550* (mounts inside cooler)

XXX Please specify color when ordering. See Color Chart on page I-A for colors available.

*See Detailed Parts Section for further breakdown.

MODELS HBW 8A and 13A

MODEL#	MFG DATE S/N ENDING	COLD WATER CAP*	COMP H/P	VOLTAGE ± 10	PH	HZ	TOTAL AMPS	R-12 REFRIG CHARGE*	WATER INLET PSIG
HBW 8A	M2 & older	8GPH	1/5	115	1	60	4.3	6.5 oz.	20-90
HBW 13A	M2 & older	13GPH	1/5	115	1	60	4.3	6.5 oz.	20-90

HEIGHT: 36¼"

WIDTH: 18"

DEPTH: 9½"

*ARI ratings: capacity at GPH cooled to 50° with 90°F ambient temperature and 80°F inlet water.

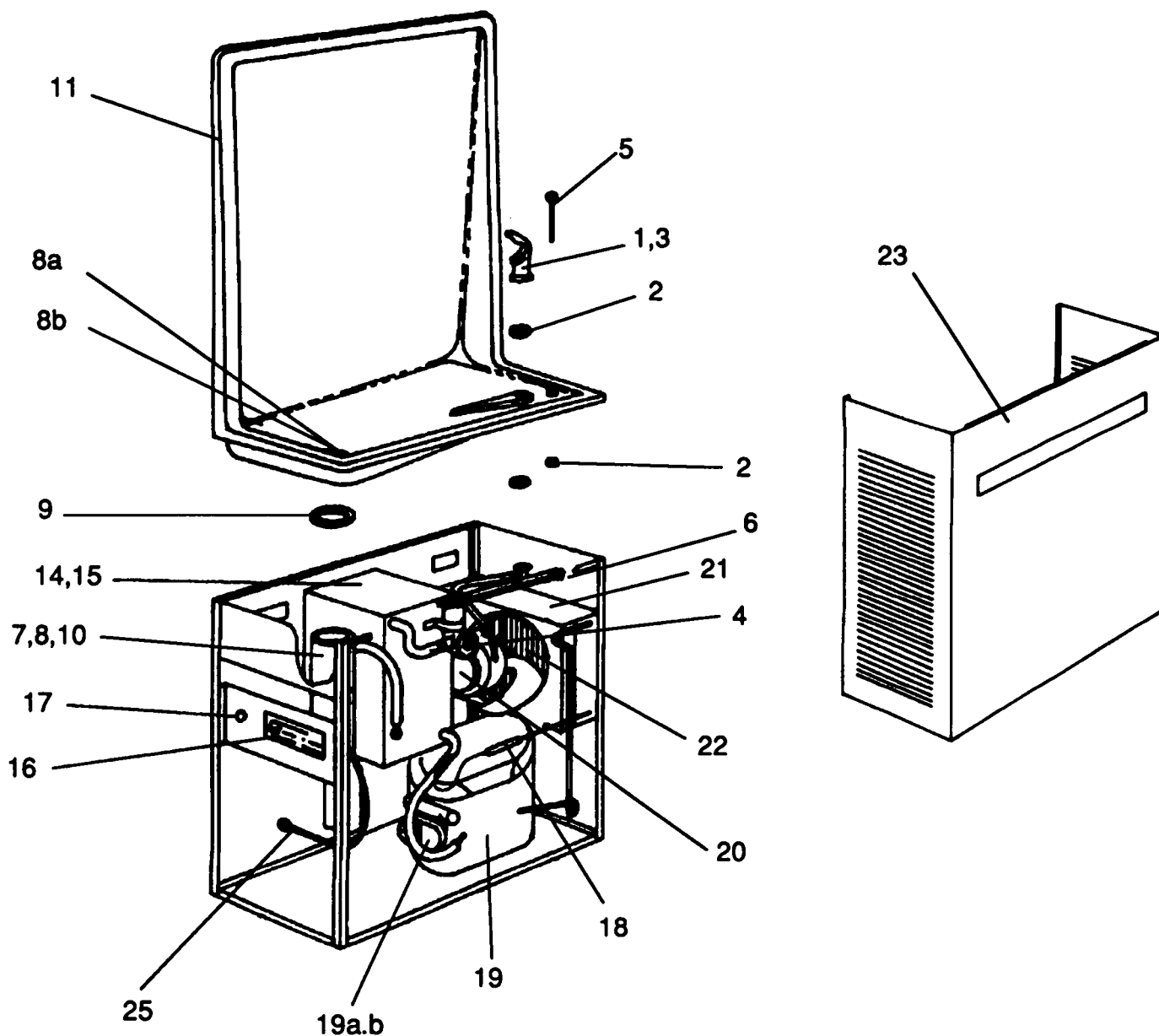

To order parts, contact your nearest Halsey Taylor wholesaler or representative.

Continued product improvement makes specifications subject to change without notice.

Halsey Taylor.