

MODELS SCWT14FL and SCWT14FL-1

SCWTFL14 and SCWT14FL-1 PART LIST

REF NO.	PART NUMBER	DESCRIPTION	SCWT14 cooler only	SCWT14-1 cooler only	side fountrn
1	10-14228-31-640	Projector	X	X	X
2	10-03227-40-560	Projector Gasket (2 each)	X	X	X
3	10-14224-31-550	Projector Nipple	X		X
3	16-42293-16-550	Projector Nipple		X	
4A	60-26229-51-550	Regulator Assembly*		X	
4B	60-14200-51-740	Valve Assembly*			X
4C	6014800-51-550	Regulator Assembly*	X		
4a	60-14549-51-550	Valve Assembly (included in item 4)*		X	
4b	60-08050-51-550	Regulator Repair Kit (for item 4A,B,C)*		X	X
4c	60-14202-51-550	Stem Assembly (included in item 4A,C)*		X	
5	60-08240-51-640	Lever Handle Stem Assembly*			X
6	60-26884-51-550	Projector Supply Line		X	
6	60-08344-51-550	Projector Supply Line			X
7	60-26615-51-550	Valve to Chiller Supply Line		X	
8	60-14511-51-550	Push Button Assembly*	X	X	
9	10-14523-31-870	Stem Bushing	X	X	
10	40-26741-43-730	Lever Arm	X	X	
11	10-06876-08-640	Glass Filler Plug Button (not shown)	X	X	
12	10-26399-31-640	Drain Plug (included in 15A)	X	X	
12	16-16373-08-640	Drain Plug	X	X	
13	16-02705-08-640	Strainer Plate (included in 15A)	X	X	
14	10-01471-40-560	Waste Gasket	X	X	
15A	60-27043-51-550	Precooler	X	X	
15B	60-15732-51-550	Wasteline Assembly	X	X	
16	10-14514-31-550	Precooler Baffle	X	X	
17	41-15642-08-640	Locknut	X	X	
18	11-01158-24-740	Fiber Gasket	X	X	
19	16-01185-08-550	Cap	X	X	
20	60-15528-51-550	Evaporator Chiller		X	
20	60-15038-51-550	Evaporator Chiller	X		
21	19-42339-51-550	Temperature Control	X	X	
22	60-15573-51-550	Compressor	X	X	
22a	19-14062-51-550	Relay (included in 22)	X	X	
22b	19-14061-51-550	Overload (included in 22)	X	X	
23	19-14761-51-550	Fan Motor	X	X	
24	SEE FAN NOTE**	Fan Blade**	X	X	
25	40-26720-43-730	Fan Bracket	X	X	
26	40-14528-31-560	Fan Shroud	X	X	
27	19-15080-51-550	Condenser	X	X	
28	10-10800-51-010	Drier	X	X	
29	19-26684-51-550	Wiring Assembly		X	
29	19-14191-51-550	Wiring Assembly	X		
30	29-14568-51-550	Capillary Tube	X	X	
31	17-14037-42-590	Receptor	X	X	
31	17-26136-42-590	Receptor			X
32	11-26275-43-890	Receptor Screws (4 each)	X	X	
33	40-15074-43-XXX	Front Panel (not shown)	X	X	
34	40-15362-43-XXX	Right Side Panel	X	X	
35	40-15375-43-XXX	Left Side Panel	X	X	
36	11-10083-43-890	Panel Screws (40 each)	X	X	
37	40-14043-31-560	Black Toe Plate (not shown)	X	X	
38	11-15078-43-560	Toe Plate Screws (2 each)	X	X	
39	13-14845-31-560	Black Trim Panel (not shown)	X	X	
40	13-14905-31-920	Name Plate (not shown)	X	X	
41	40-26729-43-730	Back Panel	X	X	
42	40-15397-43-730	Chiller Shelf	X	X	
43	40-15076-43-730	Base	X	X	
44	40-14050-31-550	Valve Bracket	X	X	
45	40-07389-43-730	Cover Plate			X
ACCESSORIES AVAILABLE	Glass Fillers – See Spec Book Glass Filler Installation Kit – 73-15238-51-550 Water Filtration Kit – 73-15242-51-550* (mounys external to cooler) 73-15423-51-550* (mounts inside cooler) Foot Pedal Kit – 73-14703-51-550* Vandal Proof Kit – 73-15243-51-640*				

XXX Please specify color when ordering. See Color Chart on page I-A for colors available.

*See Detailed Parts Section for further breakdown.

FAN NOTE: If current fan screws on, use 10-42095-43-730. If it does not, use 10-42343-43-730.

MODELS SCWT14FL and SCWT14FL-1

MODEL#	MFG DATE S/N ENDING	COLD WATER CAP*	COMP HP	VOLTAGE ± 10	PH	HZ	TOTAL AMPS	R-12 REFRIG CHARGE*	WATER INLET PSIG
SCWT14FL-1	A88 - H88	14GPH	1/5	115	1	60	4.9	7.25 oz	20-90
COOLER:		HEIGHT: 40"	WIDTH: 16"			DEPTH: 13¼"			
FOUNTAIN:		HEIGHT: — —	WIDTH: 10"			DEPTH: — —			
*ARI Ratings: capacity at GPH cooled to 50° with 90°F ambient temperature and 80°F inlet water.									

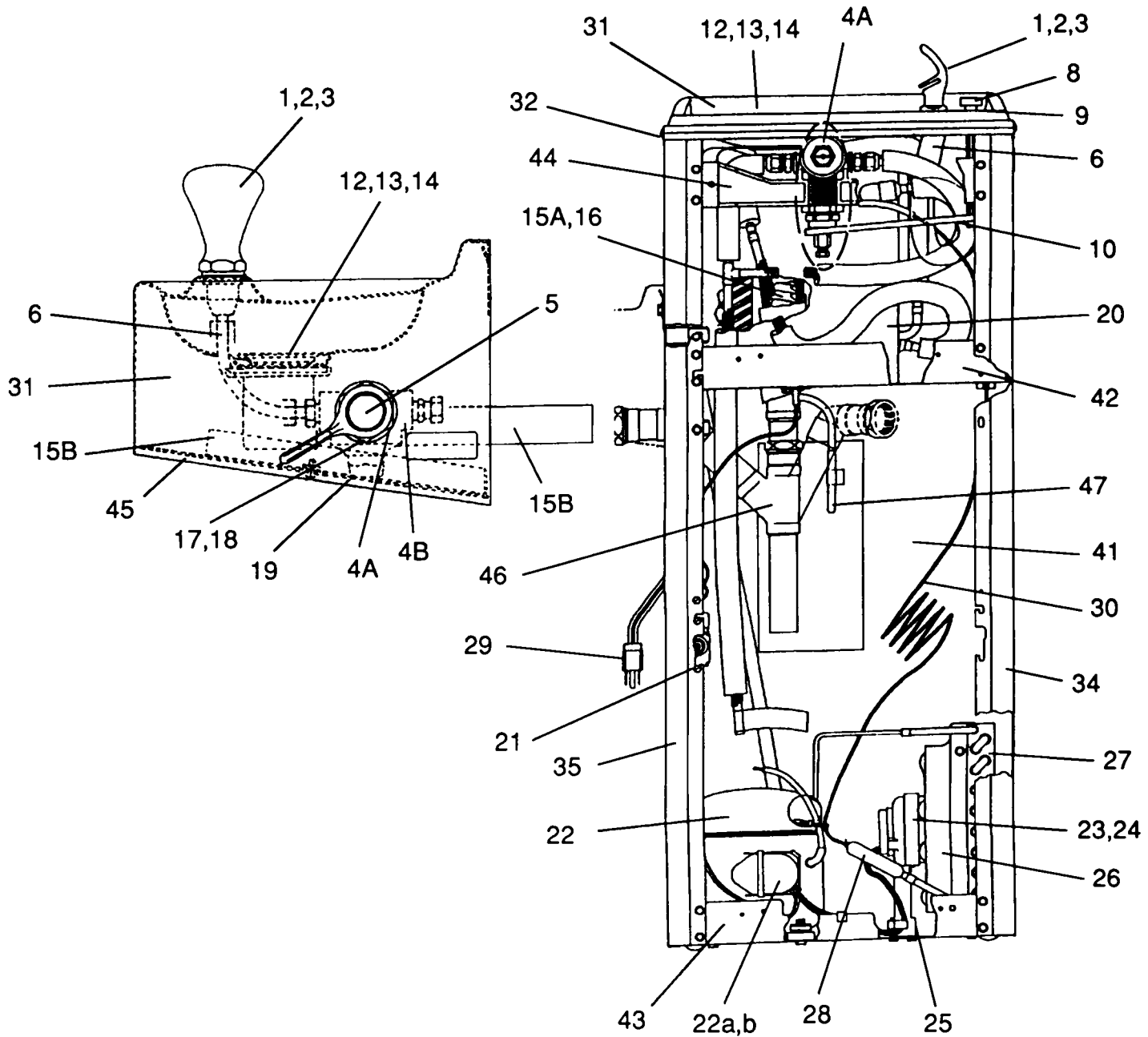

To order parts, contact your nearest Halsey Taylor wholesaler or representative.

Continued product improvement makes specifications subject to change without notice.

Halsey Taylor.